

General Notes :  
 Do not scale off this drawing. Do not rely on this drawing for purposes other than that stated in the title block Status.  
 Read this drawing with all other project related architects drawn and specified information including risk assessments.  
 Constructors must be familiar with the client's building asbestos register ahead of facilitating work contained on this drawing.

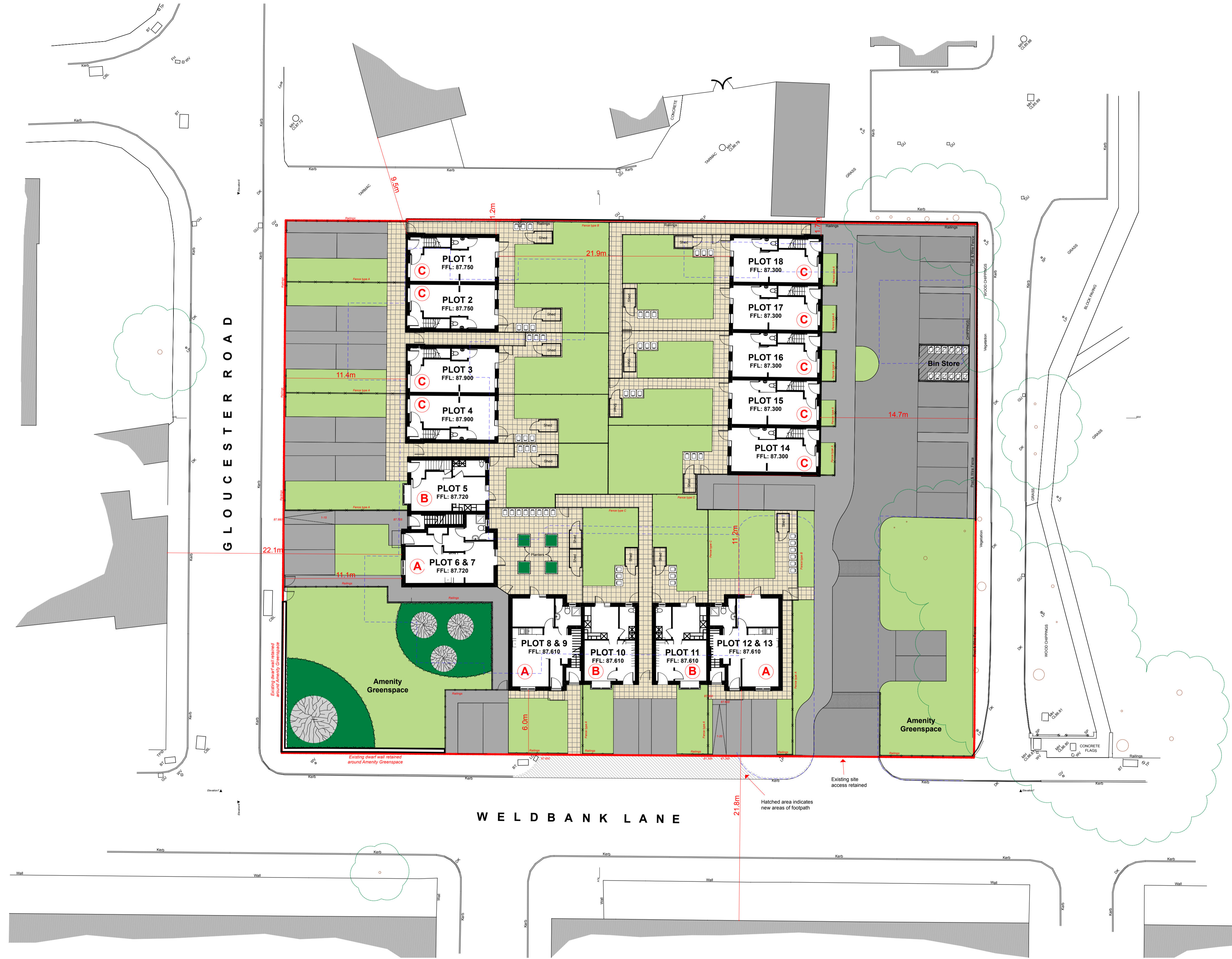

- KEY**
- Tarmac roads
  - Concrete flagged paving
  - Green/soft landscaping
  - Proposed tree
  - Existing tree retained
  - Line of existing kerbs/buildings

TYPE A units - 1B2P apartments - 6No.  
 TYPE B units - 2B4P houses - 3No.  
 TYPE C units - 2B4P houses - 9No.  
**TOTAL - 18No. units**

F	Additional notes added	13.11.15
E	Additional units omitted, terrace block updated, planters to plots 6-4 rear, railings to greenspace omitted	12.10.15
D	Site layout amended, 2 additional units added	18.09.15
C	Plots 8-13 repositioned, boundary treatments amended	14.08.15
B	Site layout updated, plots 14-18 amended to terrace	29.07.15
A	Site layout updated following Client comments	26.06.15

**Halsall Lloyd Partnership**  
 ARCHITECTS & DESIGNERS  
 Liverpool 0151 7088944 Nottingham 0115 9897969 Newcastle 0191 4950055 Preston 01772 719996

Client <b>Chorley Community Housing</b>	Title <b>Proposed Site Layout</b>
Project <b>Weldbank Lane, Chorley</b>	Status <b>PLANNING</b>
Job No. <b>P1258</b>	Drwg No. <b>103</b>
Rev. <b>F</b>	Scale @A1 <b>1-200</b>
Date <b>26.06.14</b>	Revisions

This drawing is protected by the copyright of the Halsall Lloyd Partnership Architects & Designers